

**CBS - bulb screw clamps for HP-profiles**



**Properties**

- Equipped with a thread spindle for easy attachment, providing a powerful clamping force on the workpiece
- Lightweight design for easy handling
- Tough quality heavy duty body
- Maintenance-friendly, easy to exchange parts which are available upon request

**Application**

- For use as a (temporary) lifting point in spaces with HP- (bulb) profiles, like sectional ship parts and ship engine rooms.
- The moment a load is applied, the clamp is automatically applied.
- Used for HP-100 to HP-240 (bulb) profiles.
- Working load limit (WLL) 1500 - 3000kg.

**Norm:**

- EN12100-1/2, EN13155

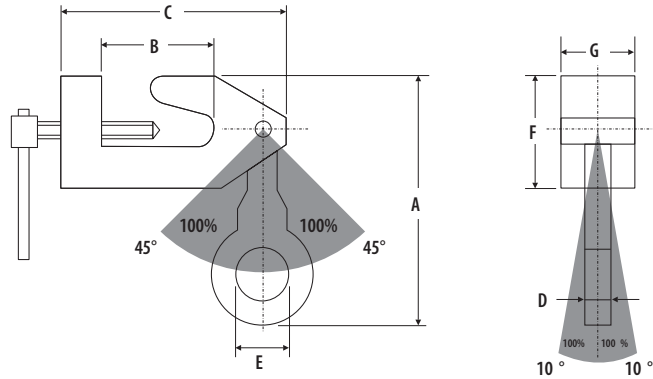

Type	WLL (kg)	Jaw opening (mm)	A (mm)	B (mm)	C (mm)	D (mm)	E (mm)	F (mm)	G (mm)	Weight (kg)	ProductId
CBS-1.5	1500	HP100-240	180	75	150	16	45	75	40	3	3313018
CBS-3.0	3000	HP100-240	205	75	150	16	45	75	80	6.5	3313019

**CBU Lightweight Holland profile (Hp) clamp for universal lifting**



Specifically developed for lifting and transportation HP profiles and ship constructions using HP profiles. Fitted with 2 cams and universal lifting eyes.

**Application**

- For vertical lifting, handling and transporting of Holland Profile (HP) shipbuilding structures from all positions
- Jaw openings available from: 0 to 45 mm
- Higher WLL available upon request . Min . WLL is 10% of max . WLL
- Lifting of longer sections should be performed with a spreader beam fitted with multiple clamps.

**Norm:**

- EN12100-1/2, EN13155, AS4991, ASME-B30,20

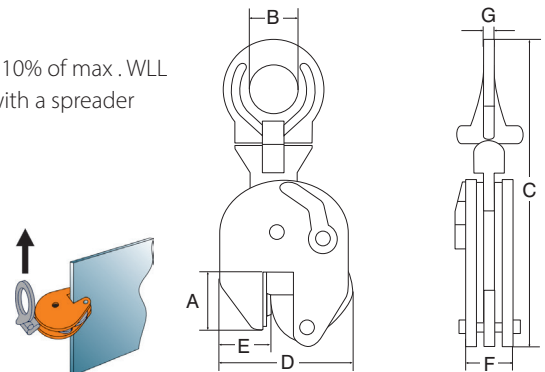

Type	WLL (kg)	Jaw opening (mm)	A (mm)	B (mm)	C (mm)	D (mm)	E (mm)	F (mm)	Weight (kg)	ProductId
CBU-3.0	3000	0-35	90	70	370	185	55	54	8	3310001
CBU-5.0	5000	0-45	110	70	435	225	60	86	17.3	3310003